

## PRE-CHECK

### 1. Warning for A/C compressor lock

If compressor lock occurs during A/C operation, the A/C switch indicator on the A/C control assembly starts blinking.

When this occurs, check for compressor lock (DTC 22) using diagnosis trouble code check then proceed to inspect the circuit or the component.

Compressor lock sensor circuit. → (See page [DI-803](#))

## 2. LIST OF OPERATION METHODS

By operating each of the A/C control switches as shown in the diagram below, it is possible to enter the diagnosis check mode.

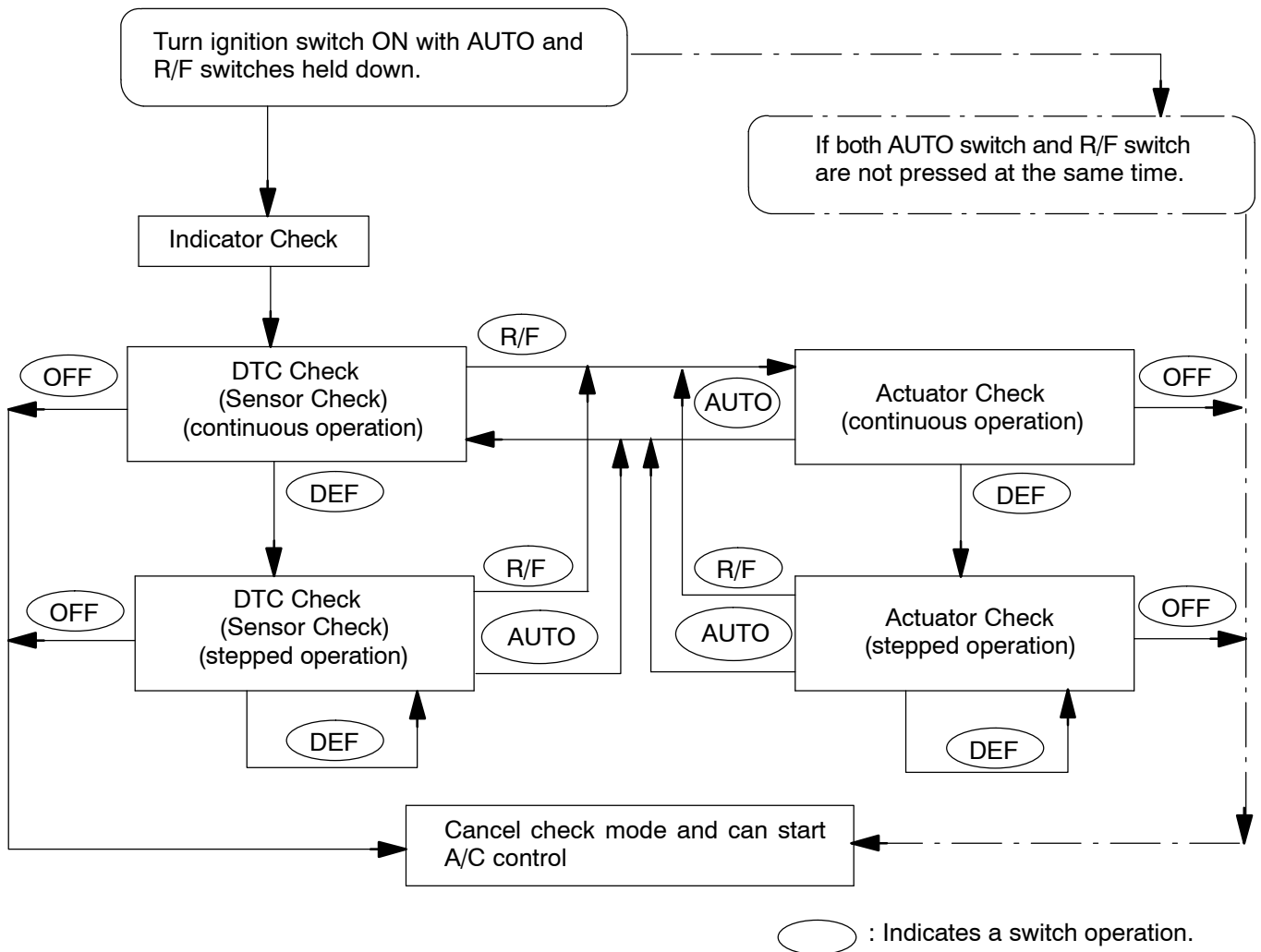

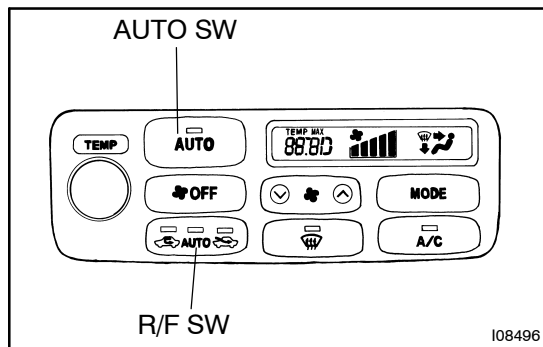

### 3. INDICATOR CHECK

- (a) Turn the ignition switch to on while pressing the A/C control AUTO switch and R/F SW simultaneously.

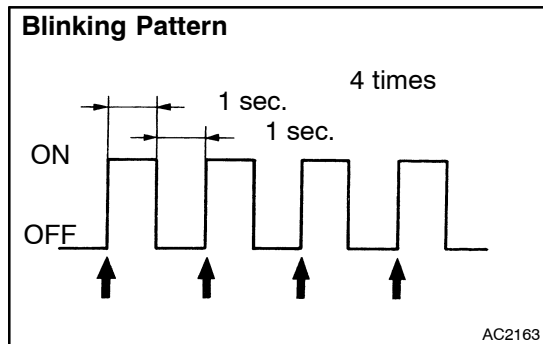

- (b) Check that all the indicators light up and go off at 1 second intervals 4 times in succession.

#### HINT:

- After the indicator check is ended, the diagnostic trouble code check begins automatically.
- Press the OFF switch when desiring to cancel the check mode.

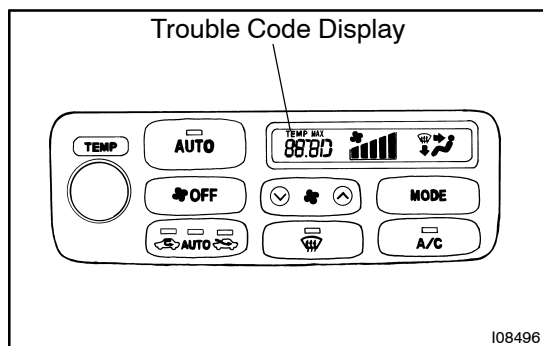

### 4. DTC CHECK (SENSOR CHECK)

- (a) Perform an indicator check. After the indicator check is completed, the system enters the DTC check mode automatically.

- (b) Read the DTC displayed on the panel. Refer to the list of DTCs on page [DI-771](#) when reading the DTCs.

(DTCs are out put at the temperature display.)

If the slower display is desired, press the Temp. Control Switch and change it to step operation. Each time the Temp. Control switch is pressed, the display changes by 1 step.

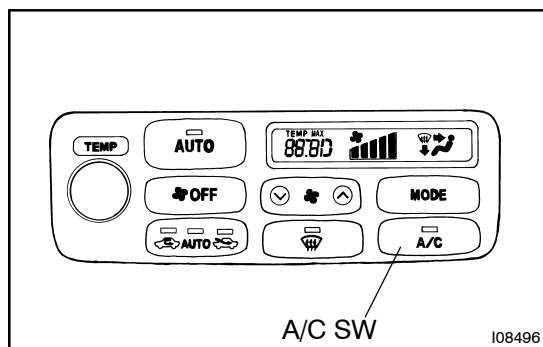

Cowl Side J/B

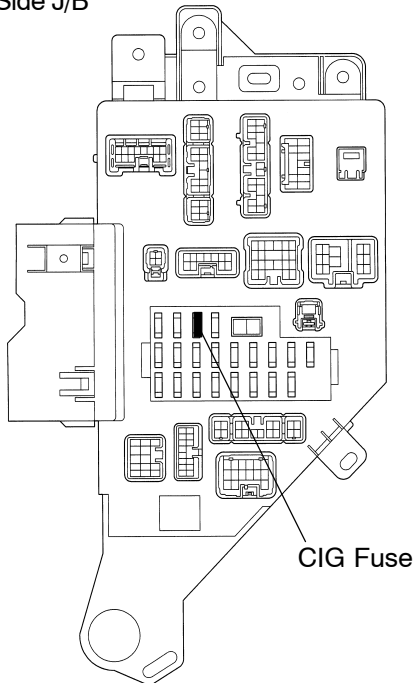

108300

**5. CLEARING DTC**

- (a) Pull out the CIG fuse in cowl side J/B for 10 sec. or longer to clear diagnostic the DTC's memory.
- (b) After reinserting the fuse, check that the normal code is output.

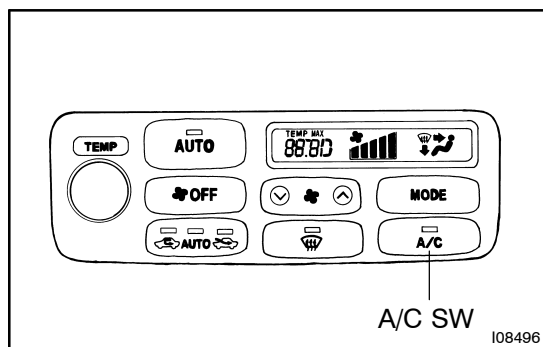
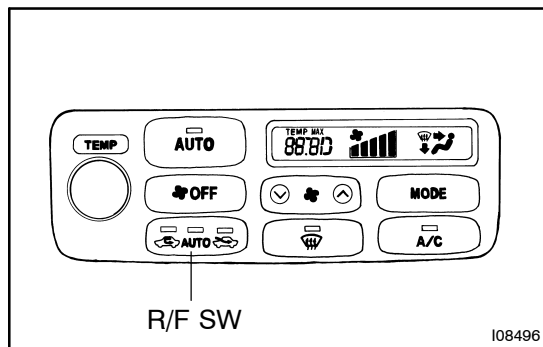

## 6. ACTUATOR CHECK

- After entering the sensor check mode, press the R/F switch.
- Since each damper, motor and relay automatically operates at 1 second intervals beginning in order from 20 in the temperature display, check the temperature and air flow visually and by hand.

If a slower display is desired, press the A/C switch and change it to step operation. Each time the A/C switch is pressed, the display changes by 1 step.

### HINT:

- The buzzer sounds when the display trouble code changes.
- Code are displayed in order from the smaller to the larger numbers.
- To cancel the check mode, press the OFF switch.

Step No.	Display code	Conditions					
		Blower motor	Air flow vent	Max. cool damper	Air inlet damper	Magnetic clutch	Air mix damper
1	0	OFF	FACE	0% open	FRESH	OFF	Cool side (-10% open)
2	1	LO	↑	↑	↑	↑	↑
3	2	MED	↑	100% open	R/F (54.5% open)	ON	↑
4	3	↑	↑	↑	↑	↑	↑
5	4	↑	↑	↑	(RECIRC)	↑	Cool / Hot (50% open)
6	5	↑	BI-LEVEL*1 (52.0% open)	↑	↑	↑	↑
7	6	↑	FOOT*2 (31.0% open)	↑	↑	↑	Hot side (110% open)
8	7	↑	↑	↑	↑	↑	↑
9	8	↑	FOOT/DEF	↑	↑	↑	↑
10	9	HI	DEF	↑	↑	↑	↑

\*1: There is air leakage from defroster.

\*2: There is no air leakage from defroster.